

SolarCam ROTATIVE

Caméra de surveillance extérieure solaire

Solar outdoor surveillance camera
Camera di sorveglianza esterna solare
Cámara de vigilancia solar exterior
Câmara de vigilância solar exterior

SVI0074

SolarCam ROTATIVE



Aide à
l'installation de
la caméra

2k

Image Haute
définition 3MP



Détection
de forme
humaine



Vision nocturne
en couleur



Fonction
enregistrement



Avertisseur
sonore et
lumineux

Notice d'utilisation et d'installation Installation and user manual

Manuale d'installazione e uso Instrucciones de uso e instalación

Manual de instruções e instalação

TABLE OF CONTENTS

A- Safety instructions	18
B- Description	19
C- Configuration	20
D- Installation	22
E- Settings	24
F- Technical features	32
G- Technical assistance	32
H- Warranty	33
I- Warnings	33
J- Declaration of conformity	33

A- SAFETY INSTRUCTIONS



This manual may be amended as the application is updated. To ensure you have the latest version, we recommend you download it from our website www.scs-sentinel.com or from the app iSCS Sentinel : settings / manual.

This manual is an important part of your product. These instructions are designed to ensure your safety. Please read them carefully before use and keep them in a safe place for future consultation. This product must only be used for its intended purpose.

This camera must not be used for street surveillance. The use of this installation must be in compliance with the French law n° 78-17 of January 6, 1978 relating to data processing, files and freedoms. It is up to the buyer to ask the CNIL about the conditions and administrative authorisations required for use outside a strictly personal context. SCS Sentinel cannot be held responsible in case of use of this product outside the laws and regulations in force.

This product works with the iSCS Sentinel app only. The application is available for free on the PlayStore and the AppStore. Application updates may be necessary, for example to fix bugs, improve features, and benefit from a better user experience. You can enable or disable automatic updates for the iSCS Sentinel application in the PlayStore or AppStore settings. The information concerning the reason for the update, its impact on the performance and the evolution of the functionalities of the product or application as well as the storage space used, are indicated, for each update, on the PlayStore or the AppStore.

In accordance with the regulations and the legal guarantee, the application availability and updates are guaranteed for a period of 2 years.

B- DESCRIPTIF

Kit content



Camera + rechargeable battery



Wall support

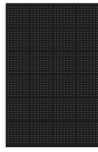

Panel solar and USB-C power cable (3m)



Wall support panel



Cable USB-A USB-C



Screws

x2



Manual

Product presentation

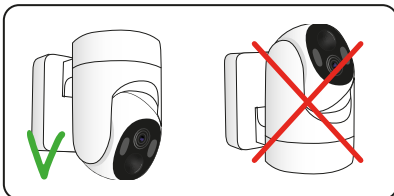
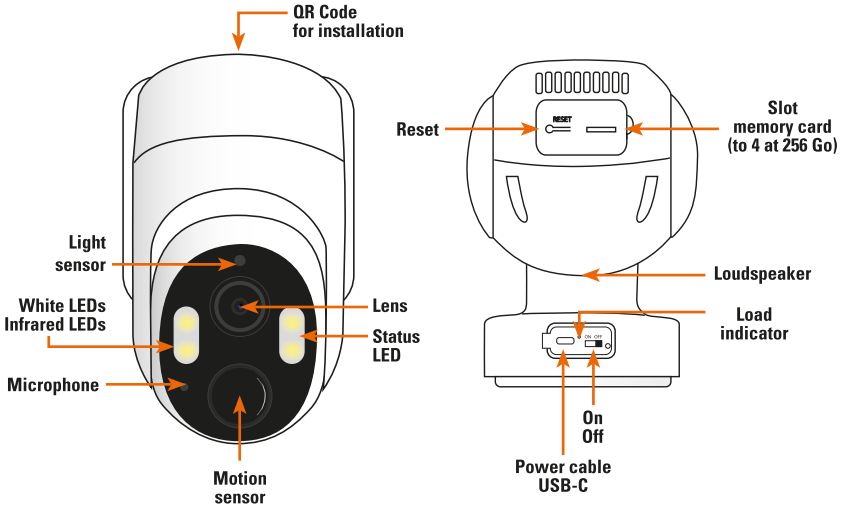

C- CONFIGURATION

Installing the app



iSCS Sentinel

To download the app, go on to the AppStore or Play Store on your smartphone. Search for "iSCS Sentinel", then click on install.

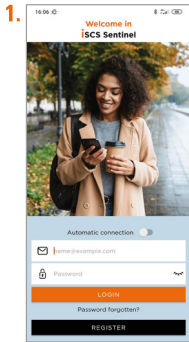

Once the download is complete, open the app and click on register.

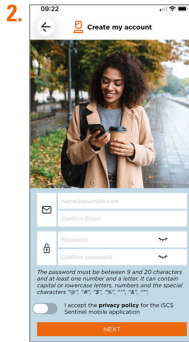

Enter your email address and password in the relevant boxes.

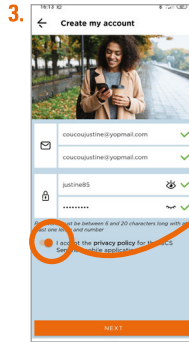

Please agree to the privacy policy before clicking next.

Click next.

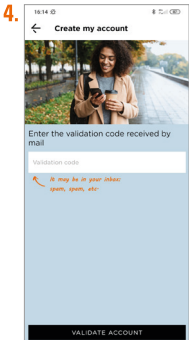

Enter the validation code you received by email. Then confirm the account.

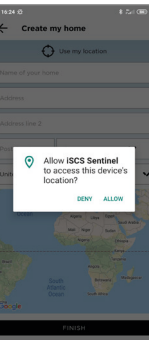
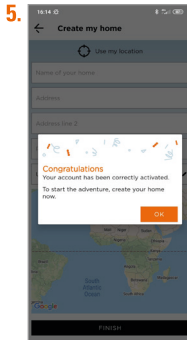

Click on ALLOW.

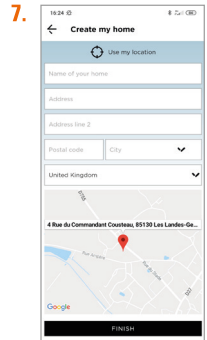

Enter all the information requested to create your home. Then click on finish.

Adding the camera



Plug the camera into a power source (it is recommended to fully charge the battery before installing the camera) and place it near your Wi-Fi router. Your phone must be connected to the same Wi-Fi network as your camera. Bluetooth and location services must be enabled.

⚠ Some materials may reduce the Wi-Fi range.

100%	Free field
80%	Wood, glass
60-70%	Plasterboard
50-70%	Stone
20-50%	Concrete
<10%	Metal

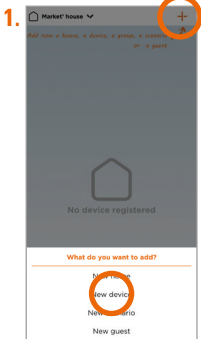

Click on **+** then on **"NEW DEVICE"** to add your camera.



Enter your wi-fi key and scan the QR code located above your camera or enter the code manually.

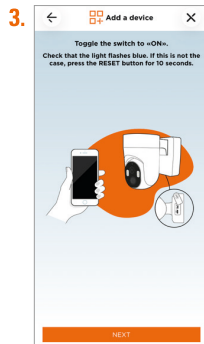

Switch the button to **"ON"** and wait until the camera emits a sound. Check that the indicator light is blinking blue. If it does not blink, press the **RESET** button for 10 seconds.



Click on **«ok»** to validate the installation

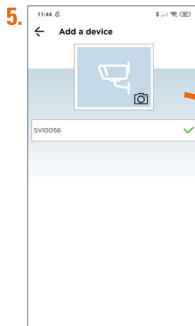

Enter a name for the camera.

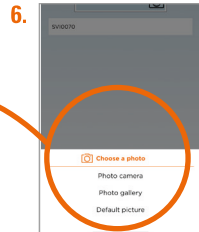

Add a profil picture from your camera, the gallery or select a picture by default (product visual or last motion capture).



If the device fails to connect to wi-fi, an error page is displayed.

Troubleshooting

1.



Check these five points.
«Clicking on "repeat operation" takes you back to the second step.

2.



Click on «use QRCode»

3.

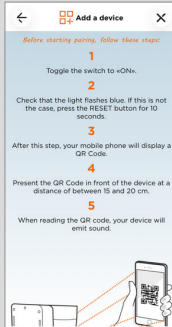

Scan the QR code displayed on your phone with the camera, then after the sound signal, press "Yes".



If "repeat operation" does not work, click on "other method"

D- INSTALLATION

Camera

- Before installation, test the camera's operation in the desired location. Check that the Wi-Fi signal strength is sufficient.
- Before connecting your camera to the solar panel, the battery must be fully charged.
- Avoid tree-lined areas or roads to avoid repeated triggering of the motion detector.
- We recommend installing the camera at a height of 2.5-3 meters.
- In the event of insufficient sunlight or prolonged use of the camera, the battery may need to be fully recharged via the USB cable supplied, to ensure optimal operation.

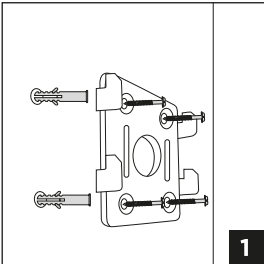

1

1. Fix the wall bracket to a smooth, flat surface using the wall plugs and screws supplied.

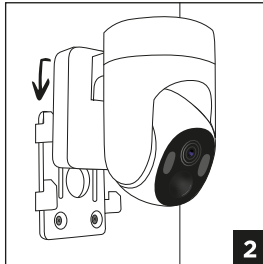

2

2. Slide the camera support onto the wall bracket from top to bottom

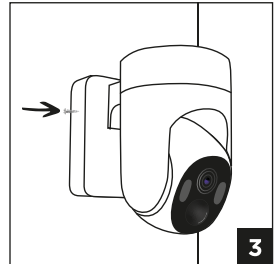

3

3. Screw the two screws into the side of the bracket.

Solar panel

- In accordance with safety standards, batteries must be charged in an environment where the temperature is between 0 and 40°C. Disconnect your solar panel outside these temperatures..

Advice :

- For best results, we recommend a south-facing panel.
- Ideal tilt angle:
 - Winter: 60° (almost vertical), as the sun is lower than the horizon.
 - Summer: 10-20° (almost horizontal), as the sun is higher above the horizon.
- Make sure the panel is not installed next to a shady area.
- Clean the solar panel regularly to keep it clean and free from dust and dirt.

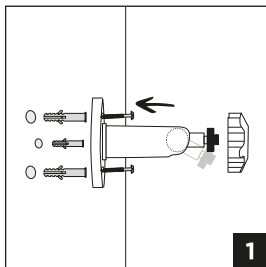
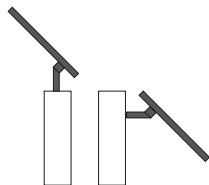

1. Drill holes on a smooth, flat surface, then fix the bracket in place using the dowels and screws supplied.

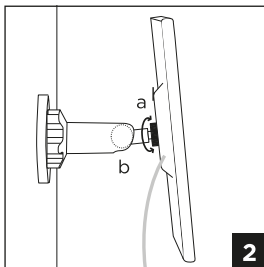

2. Screw the panel to the wall bracket (a) and make sure it's secure.
3. Set the desired panel direction (b) (See "Advice" insert).

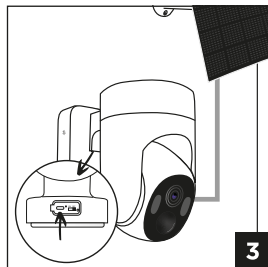

4. Connect the solar panel's USB-C cable to the camera (under the camera's mount).

E- SETTING

Application setting

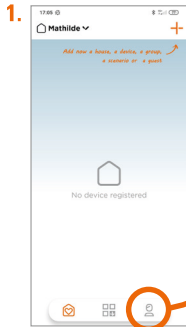

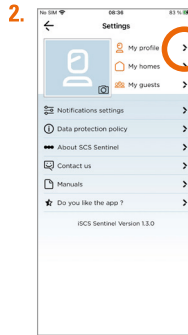

Click on  to go to the app settings.

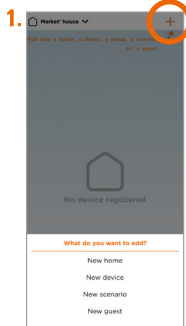

My profile:
to change personal information

To add a home



Click on 

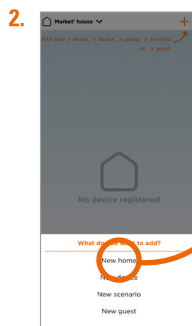

Create a new home

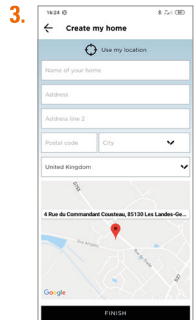

Fill in the fields and click on "finish".

To remove a home

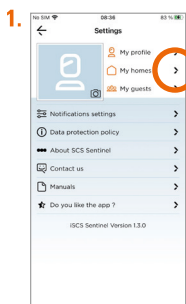

Click on 



Click on  to remove a home

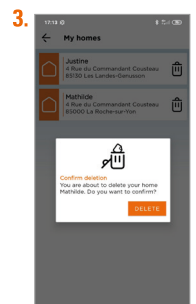

To edit a home

- 



1. Click on 
- 

2. Edit the address
- 

3.

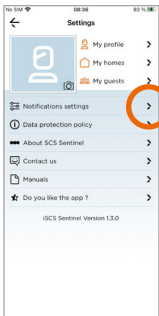
Notification settings

- 

1. Click on  to go to the notification setting
- 

2. Click on « enable notification » to activate all notifications. Otherwise click on the desired notifications.

Using the app

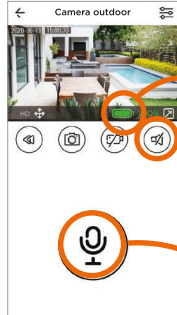
- 

1. Battery status bar

Activate listening

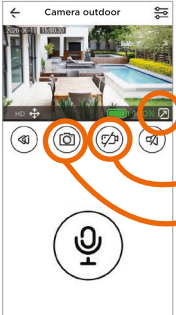
Click to speak
- 

Activate full screen (tilt the phone)

Record the video on your phone.

Take a photo on your phone.

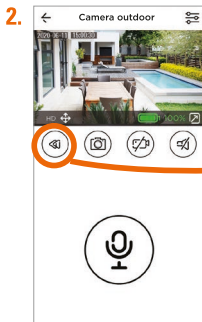

View what has happened.



Choose the date and the hour of the event to watch.

Save a video

Save a photo

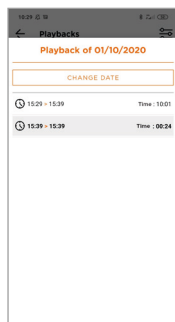

Click on «change the date» and on the required schedule to view what happened.

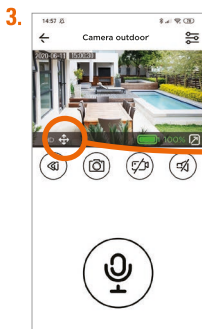

Press to activate the joystick

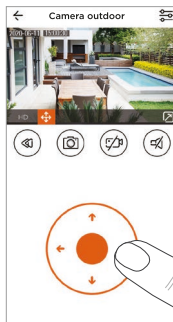

The joystick allows you to move the camera view up and down and from left to right.



A 90° viewing angle allows for a field of view of 340°. To do this, simply rotate the camera using the arrows in the app.

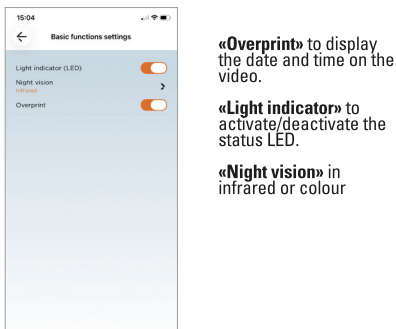
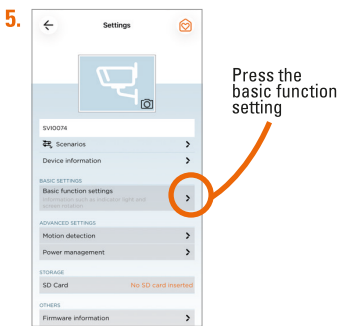
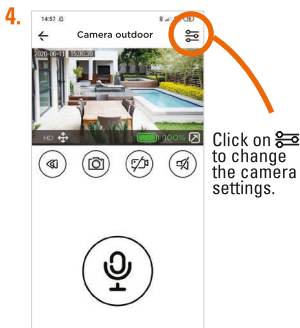

6. Viewing Motion Detection Records

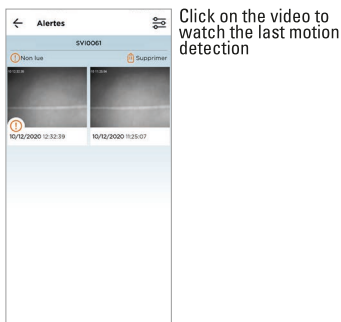
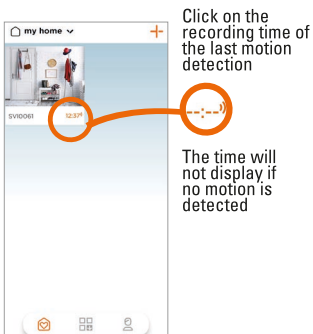

7.



Press «Sensitivity» to manage the motion sensor. Higher is the «sensitivity», the more the camera will detect a motion.

Activate or deactivate the siren and manage the volume

Click on «motion detection» to program motion detection.

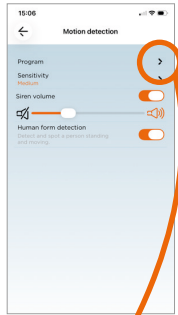
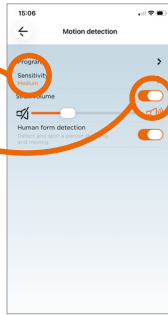

Click on «Program»

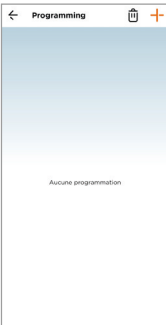

Click on +



Select the desired days and time periods for motion detection, then «CONFIRM»

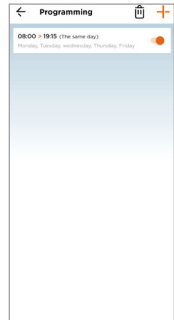

Your program has been added.

8.

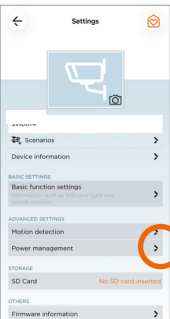

Click on «power management»

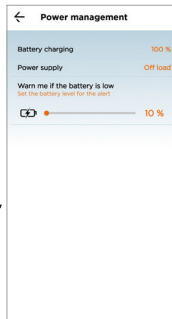

SD card settings (if there is an SD card installed in your camera)

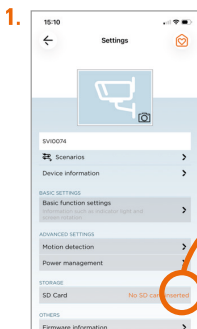

Click on "SD card" to access the settings.

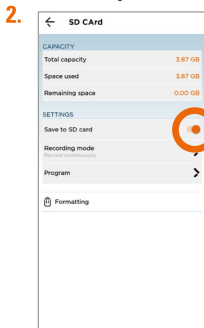

Click on "Record on SD micro card" to automatically save photos and videos on your camera's SD micro card.

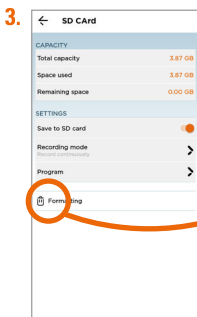

Press «Formatting» to reset your micro SD card.

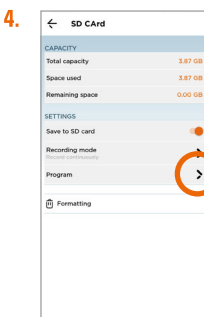

Click on "Program" to programme the periods for recording on the SD card.



Click on +

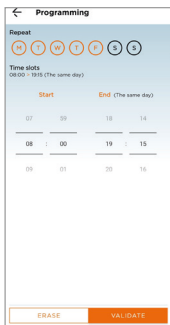

Select the desired days and time periods for saving videos/photos, then "CONFIRM"

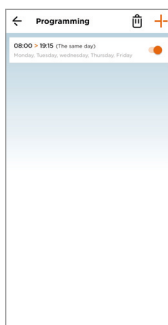

Your program has been added.

Scénarios

*Example:
I activate the motion detector on my camera every weekday at 8 a.m. for 15 minutes.*

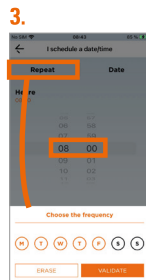

Then select the device, then motion detection, then desired state: ON

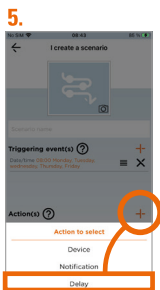

Indicate the desired time between the two actions: 0h 15m 0s

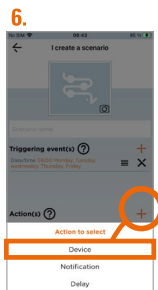

Then select the device, then motion detection, then desired state after the time limit : OFF

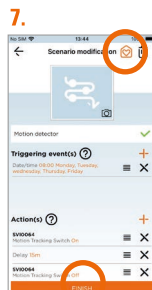

By default, the scenario will appear in the favorites list.



The scenario is activated

▶ Activate the «actions» of the scenario without waiting for the «triggering events».

To add guests



Your guest must install the iSCS Sentinel app and create an account. This will allow them to activate/deactivate devices, but they will not be able to configure them.

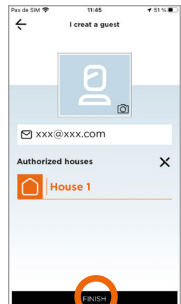
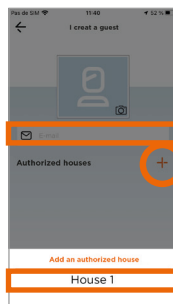
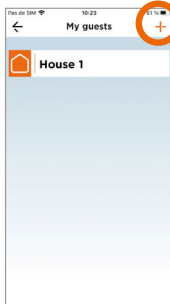
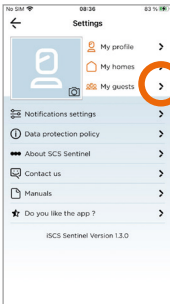

Reset

To reset the camera, press & hold the button during 10 seconds. This will remove camera pairing to your Wi-Fi network.

To completely remove the device, you will need to delete it in the app.

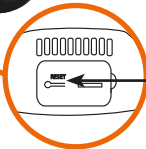
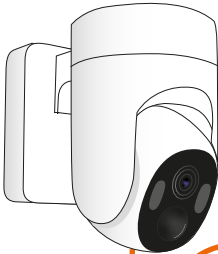

Button
reset



F- TECHNICAL SPECIFICATIONS

Camera

Resolution	2304*1296
Input voltage	5V DC
Wi-Fi range	30 m free-field range
Compatibility	iOS, Android
Motion detection/Night vision	Yes, up to 7 m
Memory card	Micro SD up to 256 Go (not supplied)
Video recording	Yes (on SD micro card not supplied)
View angle	H 90°/ V50°
Operating frequency	2402-2480 MHz (BLE) (e.r.p<100mW) 2412MHz-2472 MHz (Wifi 2,4GHz) (e.r.p<100mW) 5150-5250 MHz ; 5475-5825 MHz (Wifi 5 GHz) (e.r.p<100mW) In these countries, the use of the equipment is limited to indoor use only in the 5150–5350 MHz frequency range: BE, BG, CZ, DK, DE, EE, IE, EL, ES, FR, HR, IT, CY, LV, LT, LU, HU, MT, NL, AT, PL, PT, RO, SI, SK, FI, SE
Battery capacity	6600 mAh
Protection rating	IP65

Solar panel

Output voltage	5V DC
Output power	1A
Output power	3W

G- TECHNICAL ASSISTANCE

Troubleshooting assistance

Problem encountered	Solutions
If adding the camera fails	<ul style="list-style-type: none">- Check that the camera is switched on (ON) and the battery is charged.- Check that you are connected to Wi-Fi.- When typing the Wi-Fi password, do not type spaces or dashes.- The Wi-Fi network name must not contain any special characters.- Check that you have entered the Wi-Fi password correctly.- Check that your box is connected to the Internet.- Make sure you have sufficient bandwidth.- Check that your smartphone is on the same network as the one entered in the application.- Pair up within 3 m of the Wi-Fi box.- Contact your ISP to check your box settings (UPNP enabled, MAC address filtering disabled, SSID not masked, DHCP enabled, VPN or Proxy disabled).

Online assistance



Any question ?

For an individual answer, use our online chat on our website www.scs-sentinel.com

H- WARRANTY

Keep the barcode in a safe place, along with proof of purchase these will be requested if you need to use the warranty.

It is essential to keep proof of purchase throughout the legal warranty period.

Not covered by the warranty:

- Material and electrical damage resulting from incorrect installation.
- Damage resulting from improper use (other than for its intended purpose) or modifications.
- Damage resulting from the use and/or installation of parts not included or recommended by SCS Sentinel.
- Damage DUE to a lack of maintenance or impact.
- Damage RESULTING from poor weather, such as hail, lightning or strong winds.
- Returns without a copy of the invoice or proof of purchase.

I- WARNINGS

- Do not install near heat sources.
- To avoid electrical hazards, do not use the product if it is damaged.
- Please contact the seller for assistance if you have any problems with the product and do not attempt to disassemble or repair the product without authorisation.
- Do not use solvents to clean the product; use a soft cloth instead.
- Do not use the device and its battery in extreme conditions (very low or very high temperatures, high altitude, etc.) during use, storage or transport.
- Warning: The device and its battery must not be exposed to excessive heat or flames.
- Never damage the device and its battery.
- Never short-circuit the battery.



Do not dispose of batteries, accumulators and end-of-life devices with household waste. The dangerous substances that they are likely to include may harm health or the environment. Make your retailer take back these products or use the selective collect of garbage proposed by your city.

== Direct current

IP 65 : The outdoor unit is protected against dust and water jets from all directions.



J- DECLARATION OF CONFORMITY

Hereby, SCS Sentinel declares that this product complies with the essential requirements and other relevant provisions of Directive 2014/53/UE. The UE declaration of conformity may be consulted on the website : www.scs-sentinel.com/downloads.

Toutes les infos sur :
www.scs-sentinel.com



SCS sentinel

110, rue Pierre-Gilles de Gennes
49300 Cholet - France

